

## Lift Options

### Cordless Spring Lift Roller Shade

Roller shade is operated by a heavy-duty spring mechanism. By pulling on a draw cord tassel attached to the hembar, shades can be rolled up, exposing a room to sunlight, or down, filtering light from entering a room. Spring Roller Shades are not recommended for large windows or commercial applications.

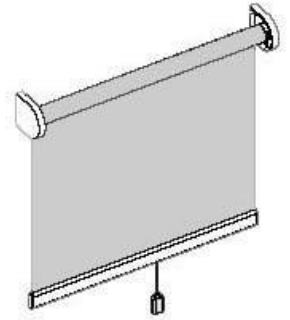

#### Size Considerations

Minimum Width:	20"
Maximum Width:	78"
Minimum Height:	18"
Maximum Height:	78"

### Cordless Deluxe Spring (surcharge option)

A heavy-duty spring-operated lift system with the added flexibility to adjust the tension so that the shade raises at the desired speed.

#### Size Considerations

(see Collection Listing for specific limitations)

Minimum Width:	18"
Maximum Width:	78"
Minimum Height:	24"
Maximum Height:	78"

### Clutch Roller Shade

#### Size Considerations

(see Collection Listing for specific limitations)

Minimum Width:	14"
Maximum Width:	120"
Minimum Height:	20"
Maximum Height:	144"

#### Chain Type Options

- Plastic Chain – standard (white or black only)
- White Metal Chain – surcharge option
- Black Metal Chain – surcharge option
- Stainless Steel Chain – surcharge option

## Railroading

In order to make a shade that is wider than the width of the roll, the fabric will be *railroaded* or turned sideways and cut to the width of the shade.

## Roller Shade Measuring & Ordering Instructions

### Selecting the Type of Mounting:

Determine whether the shade is going to be installed inside the window frame (IB) or outside the window frame (OB).

---

### Inside Mount (IB):

Inside mount installations are often preferred because the shade take up less space in the room.

### *Measuring the Width and the Length for Inside Mount:*

For the width, measure across the top, middle, and bottom of the window opening. Using the narrowest dimension, measure to the nearest  $\frac{1}{8}$ ".

For the length, measure the up and down dimension on the left, center, and right. Use the longest length measurement, measuring to the nearest  $\frac{1}{8}$ ".

Do not make any width deductions. The factory will make any appropriate deductions.

---

### Outside Mount (OB):

Outside mount installations are mounted on the wall or on the window molding. It is best to overlap the window opening at least  $1\frac{1}{2}$ " on each side when measuring for roller shades.

### *Measuring the Width and the Length for Outside Mount:*

Measure the area that the shade is to cover. For roller shades it is recommended to overlap the window opening by at least  $1\frac{1}{2}$ " on each side for a total of 3". To allow for enough space for the mounting brackets and to cover the bottom of the window, the suggested overlap for a roller shade varies depending on the size of the shade and the valance option that is selected. If the window opening has a sill, measure from where the top of the shade will be located to the top of the windowsill.

Note: When outside mount shades are specified, no factory deductions are taken from the bracket to bracket measurement. There will be a fabric deduction as outlined in this information guide.

---

### Confirming Measurements:

The most common error in ordering shades is reversing the width and the length measurements. Always confirm that the width is the measurement that goes across from left to right and that the length is the measurement that goes from top to bottom. List the width measurement first (W x L).

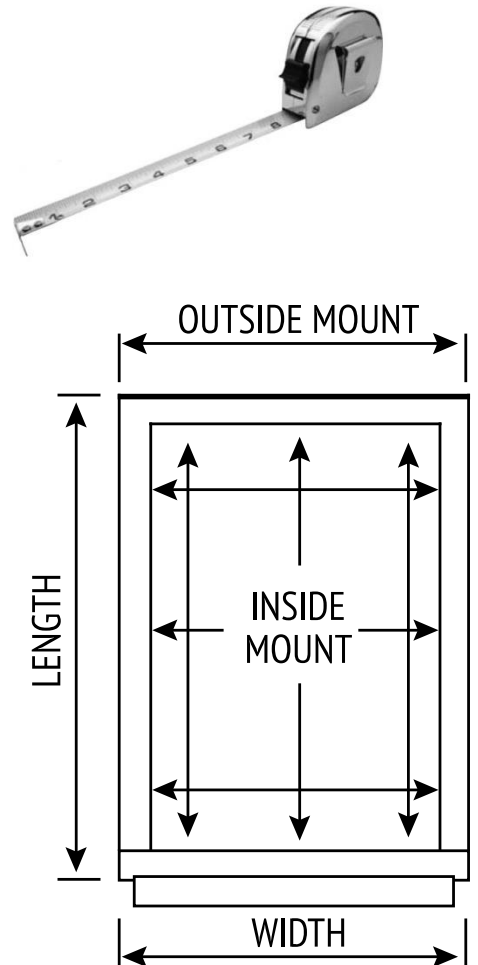

## Collection Listing

Collection Name	Color Name	Color Number	Fabric Composition	Opacity or Openness	Fabric Width	Motorization Fabric Group	Railroad	FLAME RETARDANT	GREENGUARD Certified
7500 Blackout	Almost White	R14	45% Polyester/55% Acrylic	Blackout	116"	C	No	Yes	Yes
	Black	R22							
	Grey	R17							
	Navajo	R16							
	Raw Umber	R21							
	Sand	R18							
	Skyline	R20							
	Spun White	R15							
	Taupe	R19							
	White	R13							
Amelia	Smoky	P2601	100% Polyester	Light Filtering	91"	A	No	No	No
	Millet	P2602							
	Wheat	P2605							
EconoScreen 1%	Black	ECN1-901	75% PVC/25% Polyester	1% Openness	116"	D	Yes	Yes	Yes
	Bronze/Black	ECN1-902							
	Grey/Black	ECN1-903							
	Grey/Sandstone	ECN1-203							
	Sandstone	ECN1-201							
	Snow Grey	ECN1-904							
	White	ECN1-001							
	White/Sandstone	ECN1-002							
EconoScreen 3%	Black	ECN3-901	75% PVC/25% Polyester	3% Openness	116"	C	Yes	Yes	Yes
	Bronze/Black	ECN3-902							
	Grey/Black	ECN3-903							
	Grey/Sandstone	ECN3-203							
	Sandstone	ECN3-201							
	Snow Grey	ECN3-904							
	White	ECN3-001							
	White/Sandstone	ECN3-002							
EconoScreen 5%	Black	ECN5-901	75% PVC/25% Polyester	5% Openness	116"	C	Yes	Yes	Yes
	Bronze/Black	ECN5-902							
	Grey/Black	ECN5-903							
	Grey/Sandstone	ECN5-203							
	Sandstone	ECN5-201							
	Snow Grey	ECN5-904							
	White	ECN5-001							
	White/Sandstone	ECN5-002							

## Collection Listing

Collection Name	Color Name	Color Number	Fabric Composition	Opacity or Openness	Fabric Width	Motorization Fabric Group	Railroad	FLAME RETARDANT	GREENGUARD Certified
Fine Lines	White	P0099	100% Polyester	Sheer	90"	A	No	No	No
Genoa (PVC Free)	Chocolate	GNOA400	100% Polyester	Light Filtering	105"	A	No	No	No
	Mushroom	GNOA300							
	Rustic Brown	GNOA200							
Greyson	Flaxen	P1183	100% Polyester	Light Filtering	92"	A	No	No	No
	Flagstone Grey	P1181							
	Flint	P1182							
	White Sand	P1187							
Jerusalem (PVC Free)	Bronze	JRSLM003	100% Polyester	Room Darkening	69"	B	No	No	No
	Gold	JRSLM002							
	Gray	JRSLM004							
	Silver	JRSLM001							
Kyra	Coffee	P0804	100% Polyester	Light Filtering	71"	A	Yes	No	No
	Sand	P0802							
	Cloud	P0801							
Lyla	Champagne	P9201	15% Polyester/85% Vinyl on Polyester	4% Openness	96"	C	No	Yes	Yes
	Cockatiel Grey	P9202							
	Spice	P9203							
Matte Vinyl	Beige	MATTE 933	1-Ply Fiber Glass/Laminated 3-Ply PVC	Blackout	69"	C	Yes	Yes	No
	Black/Black	MATTE 930B							
	Fawn	MATTE 934							
	Grey/Grey	MATTE 909G							
	Linen	MATTE 926							
	White	MATTE 900							
Milan	Chocolate	MILAN7579	100% Polyester	Light Filtering	69"	A	No	No	No
	Gray	MILAN6901							
	Meringue	MILAN9315							
	Shadow White	MILAN5404							
	Taupe	MILAN9691							
Mina	Timber	P0442	23.8% Polyester/76.2% Vinyl on Polyester	7% Openness	96"	D	Yes	Yes	Yes
	Bamboo Mat	P0443							
	Thicket	P0444							
Naples	Brown	NAPL 005	100% Polyester	Light Filtering	103"	A	No	No	No
	Cotton	NAPL 001							
	Ebony	NAPL 008							

## Collection Listing

Collection Name	Color Name	Color Number	Fabric Composition	Opacity or Openness	Fabric Width	Motorization Fabric Group	Railroad	FLAME RETARDANT	GREENGUARD Certified
Palermo	Chocolate	PLRM 008	100% Polyester	Blackout	107"	C	No	Yes	Yes
	Ivory	PLRM 003							
	Linen	PLRM 002							
	Mushroom	PLRM 006							
	Sand	PLRM 004							
	White	PLRM 001							
Rosalie	Dark Beige	P0504	22% Polyester/78% Vinyl on Polyester	14% Openness	95"	C	No	Yes	Yes
	Natural	P9906							
	Chocolate	P0507							
	Charcoal	P3808							
Salon (PVC Free)	Cream	SALON 002	100% Polyester	Sheer	76"	A	No	No	No
	Off White	SALON 001							
Whitney Light Filtering	Black	WHTLF118 BLK	76% Polyester/24% Acrylic	Light Filter	116"	A	Yes	No	No
	Charcoal	WHTLF118 CRL							
	Chocolate	WHTLF118 CHT							
	Coffee	WHTLF118 CFF							
	Creme	WHTLF118 CRM							
	Ivory	WHTLF118 IVY							
	Oyster	WHTLF118 OYS							
	White	WHTLF118 WHT							
Whitney Room Darkening	Black	WHTRD118 BLK	40% Polyester/60% Acrylic	Room Darkening	116"	B	Yes	No	No
	Charcoal	WHTRD118 CRL							
	Chocolate	WHTRD118 CHT							
	Coffee	WHTRD118 CFF							
	Creme	WHTRD118 CRM							
	Ivory	WHTRD118 IVY							
	Oyster	WHTRD118 OYS							
	White	WHTRD118 WHT							
Woodland (PVC Free)	Cedar	WDLND9287	100% Polyester	Light Filtering	69"	B	No	No	No
	Maple	WDLND9259							
	Natural	WDLND8892							
Zurich	Almond	ZRCH 003	100% Polyester w/Foam Backing	Blackout	107"	C	No	Yes	No
	Marine	ZRCH 005							
	Milky	ZRCH 002							
	Pure White	ZRCH 001							
	Sand	ZRCH 004							
Zute (PVC Free)	Cream	ZUTE 1009	100% Polyester	Light Filtering	69"	A	No	No	No
	Toffee	ZUTE 1101							

## Roll Direction

### Regular Roll

Regular roll shades indicate when the shade fabric rolls off the back of the roller tube. The shade cloth will be closest to the window glass

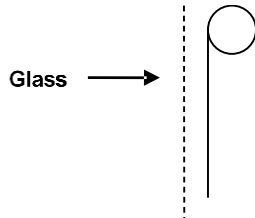

### Reverse Roll

Reverse roll shades indicate when the shade fabric rolls off the front of the roller tube. The shade cloth will be furthest from the window glass

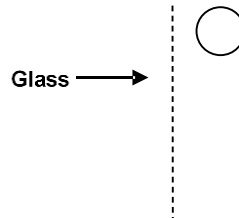

## Fascia & Cassette Options

### 3" and 4" Square Aluminum Fascia Valance

L-shaped aluminum extrusions cover the front and bottom of the roller. Valances lock to brackets by means of snap-in fittings. The roller is concealed behind the valance and the bottom of the shade drops from the back of the valance when lowered.

Roll: Available for regular roll only  
Colors: Alabaster, Black, Bronze, White & Clear Anodized

Minimum Width: 18"  
Maximum Width: 120"

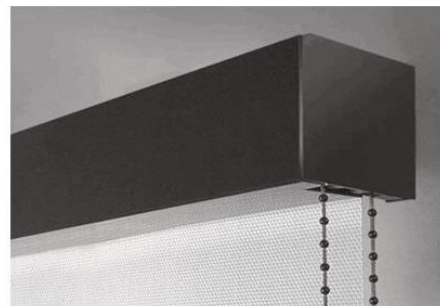

### Roller Shade Cassette with Fabric Insert

For applications requiring elegant contemporary looks, the aluminum 3 1/2" by 3 1/2" extrusion provides space for a fabric roll up to 3 inches in diameter. Snap-on mounting brackets allow for quick installation.

Roll: Available for regular roll or reversed roll  
Colors: Anodized, Alabaster, Black, Bronze or White

Minimum Width: 20"  
Minimum Length: 20"  
Maximum Width: 96"  
Maximum Length: 120"

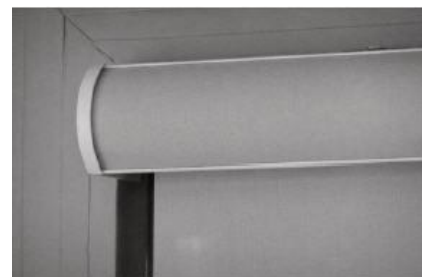

### Inserted Fabric Valance

The Inserted Fabric Valance is a traditional dust cover vertical blind valance with a 3 1/2" strip of fabric inserted into the channel of the valance.

Roll: Available for regular roll & reverse roll shades  
Color: Valance fabric matches shade fabric

Mount: Inside or Outside  
Minimum Width: 18"  
Maximum Width: 120"

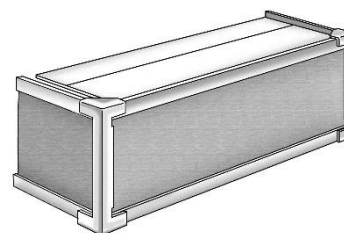

## Roller Shade Hembar & Channel Options

### Pocket Bottom weight Hembar - standard

An aluminum extrusion welded into a pocket made by folding over the fabric at the bottom of the roller shade.

Size: 1  $\frac{3}{8}$ " tall

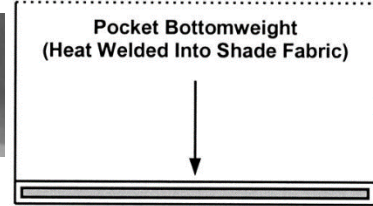
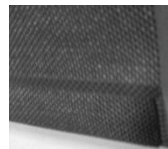

### Fabric Wrapped Hembar – surcharge option

The fabric wrapped hembar is required when hold-downs are requested.



## Roller Shade Hembar & Channel Options

### Spring Assist for Oversized Shades – surcharge option

Provides a lift assist for large, heavy shades. Spring assist required with shades 69 square feet or more

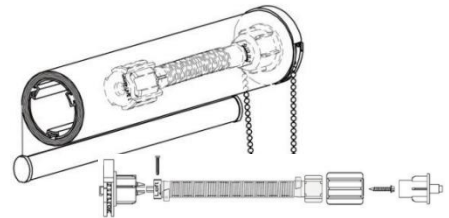

### Side & Sill Channels – surcharge option

A 2-piece U shaped aluminum extrusion used to eliminate light gaps at the sides or the bottom of a shade.

Roll: Available for regular roll and reverse roll shades  
Colors: White, Alabaster, Bronze, Black and Clear Anodized

Minimum Length: 18"  
Maximum Length: 144"  
Dimensions: 2  $\frac{1}{4}$ " wide x 15/16" deep

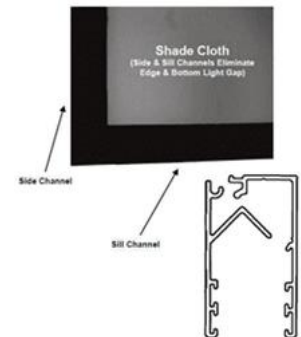

Motorization

Radio frequency motorization utilizing Somfy’s proprietary RTS (Radio Technology Somfy) protocol. Featuring operation from virtually anywhere in the house, up to 65 feet. This low voltage motorization solution requires not costly electrical hardwiring. Convenient, single-channel remote available. Motorization components and accessories have a five-year limited warranty, excluding batteries.

- Motor located on right or left side; right side is standard
- Available with standard or reverse roll; reverse roll not available with valance options
- Available with Cassette Valance and Fascia
- Not available with hold downs
- Not available with fabric seaming or railroading

Minimum Width: 14”  
Minimum Height: 13”  
Maximum size: 72” x 72



Power Size Consideration Chart (see Collection Listing)

Fabric Group	Battery Tube AA Alkaline (square inches)	Dual Battery Tube AA Alkaline (square inches)	Plug-In Transformer (square inches)
A	<5,200	<5,200	<5,200
B	<3,500	≥3,500	≥3,500
C	<2,500	≥2,500	≥2,500
D	<1,750	≥1,750 and <4,000	≥4,000

Note: 72” x 72” = 5,184 square inches in area, this is the maximum shade size, shade size maximum limit may be smaller based on fabric group.