

Sheer Shadings SIZE STANDARDS



				Sheer Shading		Rechargeable Motorization	
				Cord Loop	Cordless		
						Simplicity	PowerTouch
LIGHT FILTERING ROOM DARKENING	Minimum Width			12"	18"	21"	21"
	Minimum Length			16"	16"	12"	12"
				Sheer Shading		Rechargeable Motorization	
				Cord Loop	Cordless		
						Simplicity	PowerTouch
Light Filtering	Price Group	Page					
2" Vanes	15	63	Maximum Width & Length	120"* x 120"	84"* x 84"	120"* x 96" 60 sq ft	120"* x 96" 60 sq ft
2½" Vanes	17	64					
3" Vanes	19	65					
				Sheer Shading		Rechargeable Motorization	
				Cord Loop	Cordless		
						Simplicity	PowerTouch
Room Darkening	Price Group	Page					
2" Vanes	16	63	Maximum Width & Length	120"* x 102"	84"* x 84"	120"* x 84" 50 sq ft	120"* x 84" 50 sq ft
2½" Vanes	18	64					
3" Vanes	20	65					
				Cord Loop	Cordless	Simplicity Rechargeable	PowerTouch Rechargeable
More Information On Page				Page 66	Page 71	Page 79	Page 76

Please Note: Once ordered and manufactured, the width of the fabric cannot be altered. Comfortex makes deductions to the width depending on the type of mounting indicated. For all mounting types, fabric will measure exactly the length ordered when the vanes are in the closed position.

Tilt only shadings 6" to 1 17/8" (Standard only - No charge)

*Head rail measurements include end caps.

Sheer Shadings CORD LOOP HARDWARE SYSTEM

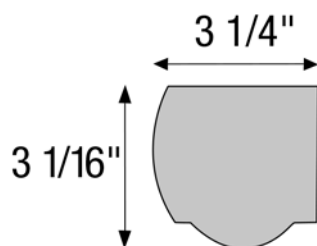
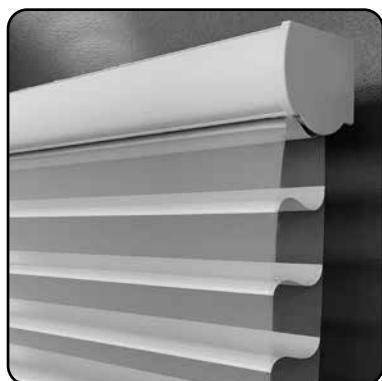

Cord Loop Rail Dimensions

- Depth of cassette: 3 1/4"
- Height of cassette: 3 1/16"

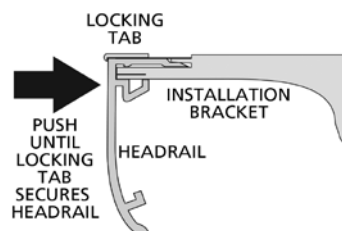

Hardware Features

Hardware colors for all fabrics	Choose from coordinating Fabric Insert or painted Smooth Face rail. Painted aluminum cassette head rail will be pre-coordinated to the fabric selection.
Cord	A color coordinated nylon cord is standard.

Mounting Dimensions

Cord Loop Hardware System

Minimum Depth Inside Mount	1"
Minimum Depth Flush Inside Mount	3 3/8"
Minimum Rear Fabric Clearance Inside Mount	1/8"
Minimum Surface Height Outside Mount	1"
Outside Mount Recommended Overlap Per Side	3"
Minimum Rear Fabric Clearance Outside Mount	1/8"

Finished Dimensions

Inside Mount

	<ul style="list-style-type: none"> • Fabric will measure ordered width less: 1" • Head rail* will measure ordered width less: 1/8"*
--	---

Outside Mount

	<ul style="list-style-type: none"> • Fabric will measure ordered width minus: 3/4" • Head rail will measure ordered width • Fabric height will measure ordered length less: 1/8"
--	---

* Head rail measurements include endcaps.

Please Note: Due to variations in fabric weave and environmental conditions, the finished dimensions for both width and length may vary, plus or minus 1/8" from your order measurements.

Sheer Shadings CORD LOOP HARDWARE SYSTEM

Applications

- Standard Rectangular

Cord Information

A nylon cord loop is used to raise and lower Sheer Shadings.

Select desired control side of the shade when ordering.

Shade Height	Loop Drop
16" to 26 ⁷ / ₈ "	12" loop
27" to 39 ⁷ / ₈ "	24" loop
40" to 59 ⁷ / ₈ "	36" loop
60" to 83 ⁷ / ₈ "	48" loop
84" to 107 ⁷ / ₈ "	60" loop
108" to 120"	72" loop

Optional Cord Drops (White Cord Only)

Cord Drop	Increments
6' to 12'	6" Increments
12' to 16'	12" Increments

Note: 18" white only cords available upon request

Length Considerations

Sheer Shadings are fabricated to the exact length ordered, when the vanes are in the closed position (Figure A).

- When the vanes are rotated to the open position, the shading will become slightly longer.
- When opened on an inside mount, the shading will be slightly longer than ordered length.
- A slight puckering may occur when the vanes are in the open position. Rotating the vanes closed will cause the bottom rail to touch the window sill, before it begins to raise.

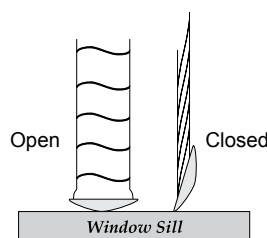

Figure A

Side By Side Alignment

When Sheer Shadings are installed side-by-side, vane alignment can be guaranteed within 1/4" only if:

- The shadings are the same color and ordered at the same time.
- The sum total of the widths of all shadings needing alignment is less than 102".
- Side-by-side lineup is specified when the order is placed.

Vane Opening

Vane opening is the amount of unobstructed visibility between fully open vanes when looking through the shading at eye level. Vane opening for shadings is up to 1 3/8"

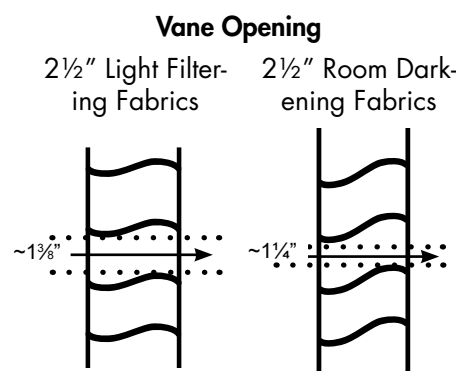

Vane Closure (Figure B)

vanes are not designed to close tightly. The inherent nature of the fabric will cause a slight increase in the distance from the front sheer to back sheer as you move further down the shading. These vanes do not form a perfect seal against light leakage which is most visible toward the bottom of the shading. Vane overlap ensures that privacy is not compromised.

Vane closure is measured as the distance between the front and rear fabric sheers 6" up from the lowest point of the bottom rail, with the shading fully lowered and the vanes closed.

On light filtering fabrics, the maximum distance from the front sheer to the back sheer when closed is equal to or less than 5/8" for shadings under 60" and 7/8" for shadings longer than 60". On room darkening fabrics, the distance is 5/8" regardless of shading length.

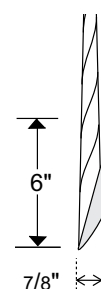

Figure B

Sheer Shadings CORD LOOP HARDWARE SYSTEM

Standard Operation

Refer to illustration below.

- Illustration 1: The shading is in the fully raised position.
- Illustration 2: Pull down on rear half of nylon cord loop to lower shading and open fabric vanes.
- Illustration 3: Pull down on front half of nylon cord loop to close vanes and raise shading

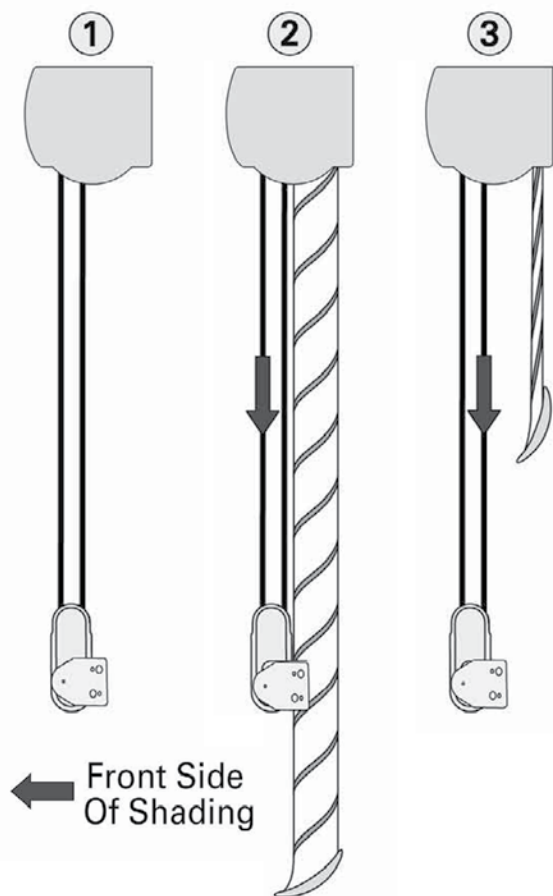

Omni-View System

The Omni-View System is exclusive to Shangri-La Sheer Horizontal Shadings and Color Lux Sheer Shadings. Omni-View is not available on Sheer Shadings.

Light Control

With the shading in the fully lowered position, the nylon cord loop is used to adjust the fabric vanes from open to closed, and anywhere in between.

Please Note: The degree of maximum vane closure varies slightly from the top to the bottom of the shading.

Shading Adjustment

After installation, windows that are not square and level may cause the shadings to shift to one side as it rolls up, requiring adjustment of the bottom rail. If the brackets are not level it may be necessary to adjust the bottom rail weight.

- To access the bottom rail weight, release the weight clip on the bottom rail by inserting a flat blade screwdriver into the weight clip in the bottom rail and turn clockwise.
- Move the weight in 1" increments toward the side where the fabric is gathering.
- Secure the weight clips in position by turning them counterclockwise after making the adjustment.

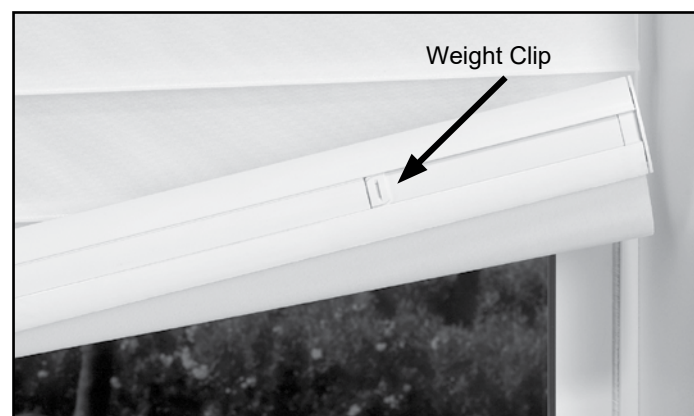

UV Protection

Ultraviolet light, entering the home as sunlight, damages furnishings. In time it fades wood floors, furniture, upholstery, draperies, carpeting and artwork. Prolonged exposure to sunlight causes natural, undyed fabrics to turn yellow, weakening their fibers and making them look old and worn prematurely.

The right window covering can be very effective in blocking ultraviolet rays. Such effectiveness is measured in terms of a "% UV blockage" rating. The higher the rating, the greater the UV protection.

Sheer Shadings fabrics have the following UV Protection ratings:

Light Filtering Fabrics	Open Vanes	88%
Room Darkening Fabric	Open Vanes	88%
All Fabrics	Closed Vanes	99%

Sheer Shadings

CORD LOOP HARDWARE SYSTEM

Magnetic Hold-Down Brackets

Optional magnetic hold-down brackets secure the bottom of the shading to prevent swaying. Please specify when ordering.

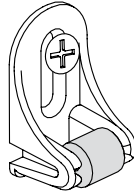

Extension Brackets

Extension or "L" brackets are available to project the back of the shading from the mounting surface. Brackets will project 2½".

Spacer Blocks

Spacer blocks project the shading ⅜" from the mounting surface. Use spacer blocks to obtain clearance when obstructions, such as window cranks or door handles, obstruct the movement of the shading.

Sheer Shadings CORD LOOP HARDWARE SYSTEM

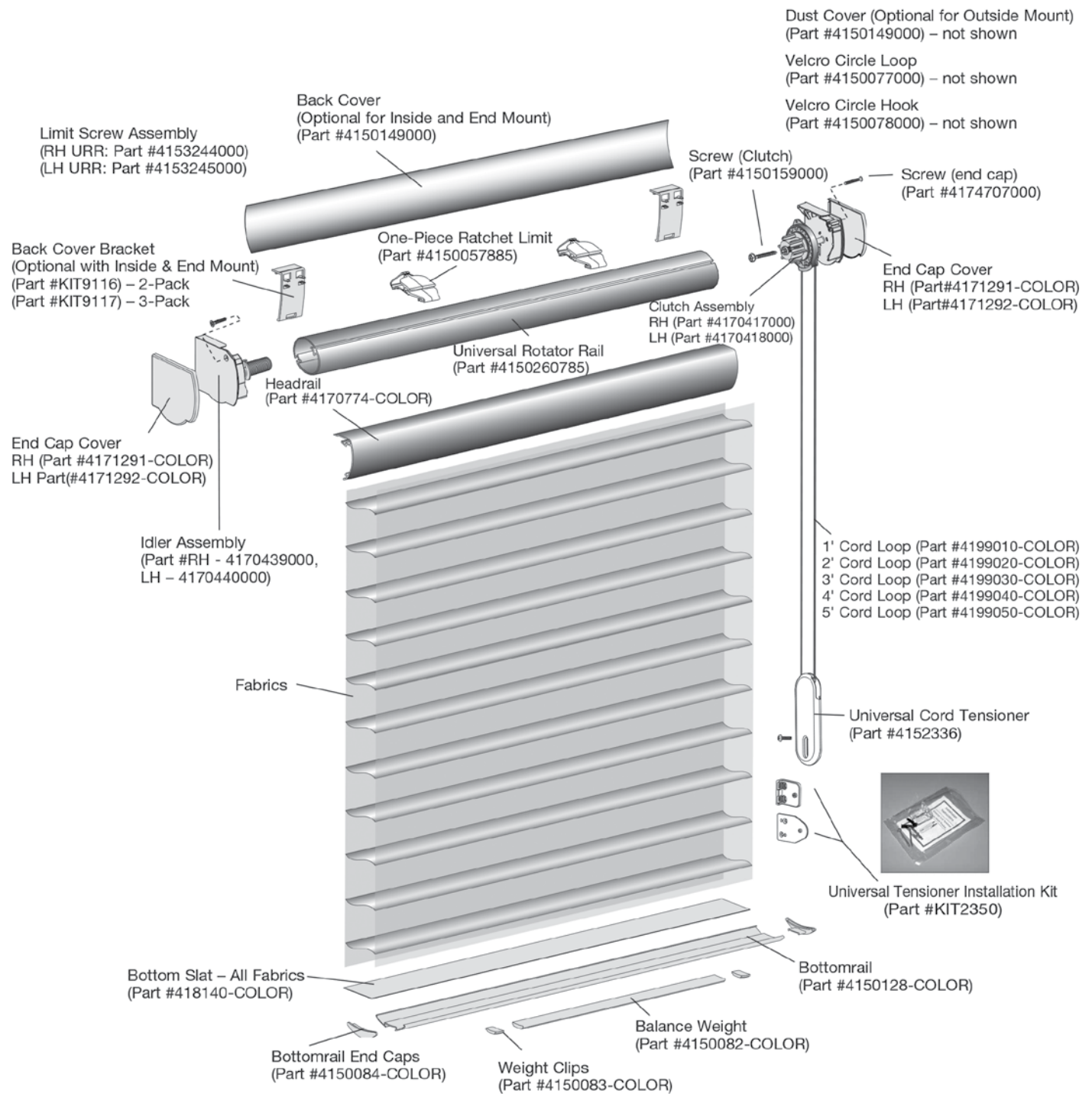

MAGNETIC HOLD-DOWN
(PART #KIT9108)



INSTALLATION
BRACKET PAIR
(PART #KIT9109)

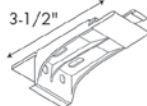

BRACKETS-3
(PART #KIT9110)

BACK COVER
BRACKET
(Part #KIT9116) – 2-Pack
(Part #KIT9117) – 3-Pack



BACK
COVER
(PART #4150149000)

INSIDE MOUNT ONLY
(OPTIONAL)

1/2" SPACER BLOCK
(PART #KIT2011) – 2 PACK
(PART #KIT2012) – 3 PACK



EXTENSION
BRACKET
(Part #KIT2013) – 2-Pack
(Part #KIT2014) – 3-Pack

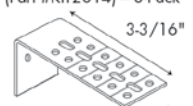

OUTSIDE MOUNT ONLY
(OPTIONAL)

Sheer Shadings CORDLESS HARDWARE SYSTEM

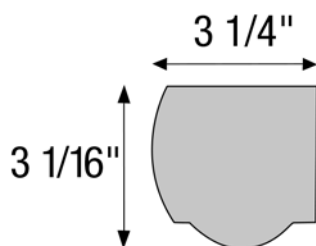
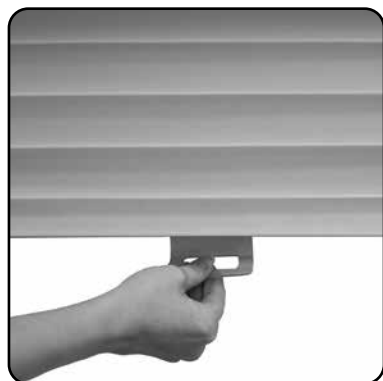

Cordless Rail Dimensions

- Depth of cassette: 3 1/4"
- Height of cassette: 3 1/16"

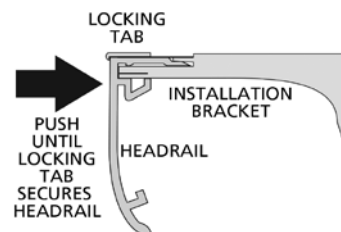

Hardware Features

Hardware colors for all fabrics	Choose from coordinating Fabric Insert or painted Smooth Face rail. Painted aluminum cassette head rail will be pre-coordinated to the fabric selection.
Handle	Clear plastic handle.

Mounting Dimensions

Cordless Hardware System

Minimum Depth Inside Mount	1"
Minimum Depth Flush Inside Mount	3 3/8"
Minimum Rear Fabric Clearance Inside Mount	1/8"
Minimum Surface Height Outside Mount	1"
Outside Mount Recommended Overlap Per Side	3"
Minimum Rear Fabric Clearance Outside Mount	1/8"

Finished Dimensions

Inside Mount

- Fabric will measure ordered width less: 1"
- Head rail* will measure ordered width less: 1/8"*

Outside Mount

- Fabric will measure ordered width minus: 3/4"
- Head rail will measure ordered width
- Fabric height will measure ordered length less: 1/8"

* Head rail measurements include endcaps.

Please Note: Due to variations in fabric weave and environmental conditions, the finished dimensions for both width and length may vary, plus or minus 1/8" from your order measurements.

Sheer Shadings CORDLESS HARDWARE SYSTEM

Applications

- Standard Rectangular

Length Considerations

Sheer Shadings are fabricated to the exact length ordered, when the vanes are in the closed position (Figure A).

- When the vanes are rotated to the open position, the shading will become slightly longer.
- When opened on an inside mount, the shading will be slightly longer than ordered length.
- A slight puckering may occur when the vanes are in the open position. Rotating the vanes closed will cause the bottom rail to touch the window sill, before it begins to raise.

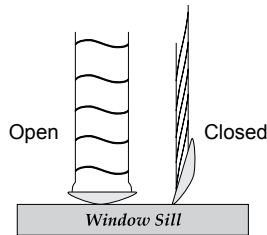

Figure A

Side By Side Alignment

When Sheer Shadings are installed side-by-side, vane alignment can be guaranteed within 1/4" only if:

- The shadings are the same color and ordered at the same time.
- The sum total of the widths of all shadings needing alignment is less than 102".
- Side-by-side lineup is specified when the order is placed.

Vane Opening

Vane opening is the amount of unobstructed visibility between fully open vanes when looking through the shading at eye level. Vane opening for shadings is up to 1 3/8"

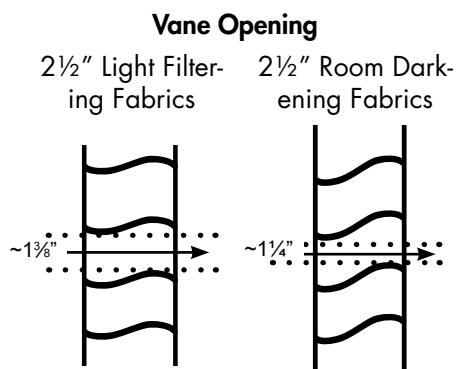

Vane Closure (Figure B)

vanes are not designed to close tightly. The inherent nature of the fabric will cause a slight increase in the distance from the front sheer to back sheer as you move further down the shading. These vanes do not form a perfect seal against light leakage which is most visible toward the bottom of the shading. Vane overlap ensures that privacy is not compromised.

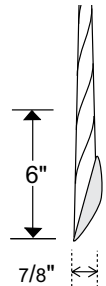

Figure B

Vane closure is measured as the distance between the front and rear fabric sheers 6" up from the lowest point of the bottom rail, with the shading fully lowered and the vanes closed.

On light filtering fabrics, the maximum distance from the front sheer to the back sheer when closed is equal to or less than 5/8" for shadings under 60" and 7/8" for shadings longer than 60". On room darkening fabrics, the distance is 5/8" regardless of shading length.



Bottom Rail with Vanes Closed



Bottom Rail with Vanes Opened

To Lower Cordless Shading

Pull down on the hinged pull until the shade is at the desired height.

To Raise Cordless Shading

Gently pull down on the hinged pull. To raise the shade completely, simply release the pull and the shade will roll up fully into the head rail. To raise the shade partially, when the shade is at the desired height, gently pull on the tassel to stop the shade from raising.



Cordless Handle on Window Sill

Sheer Shadings CORDLESS HARDWARE SYSTEM

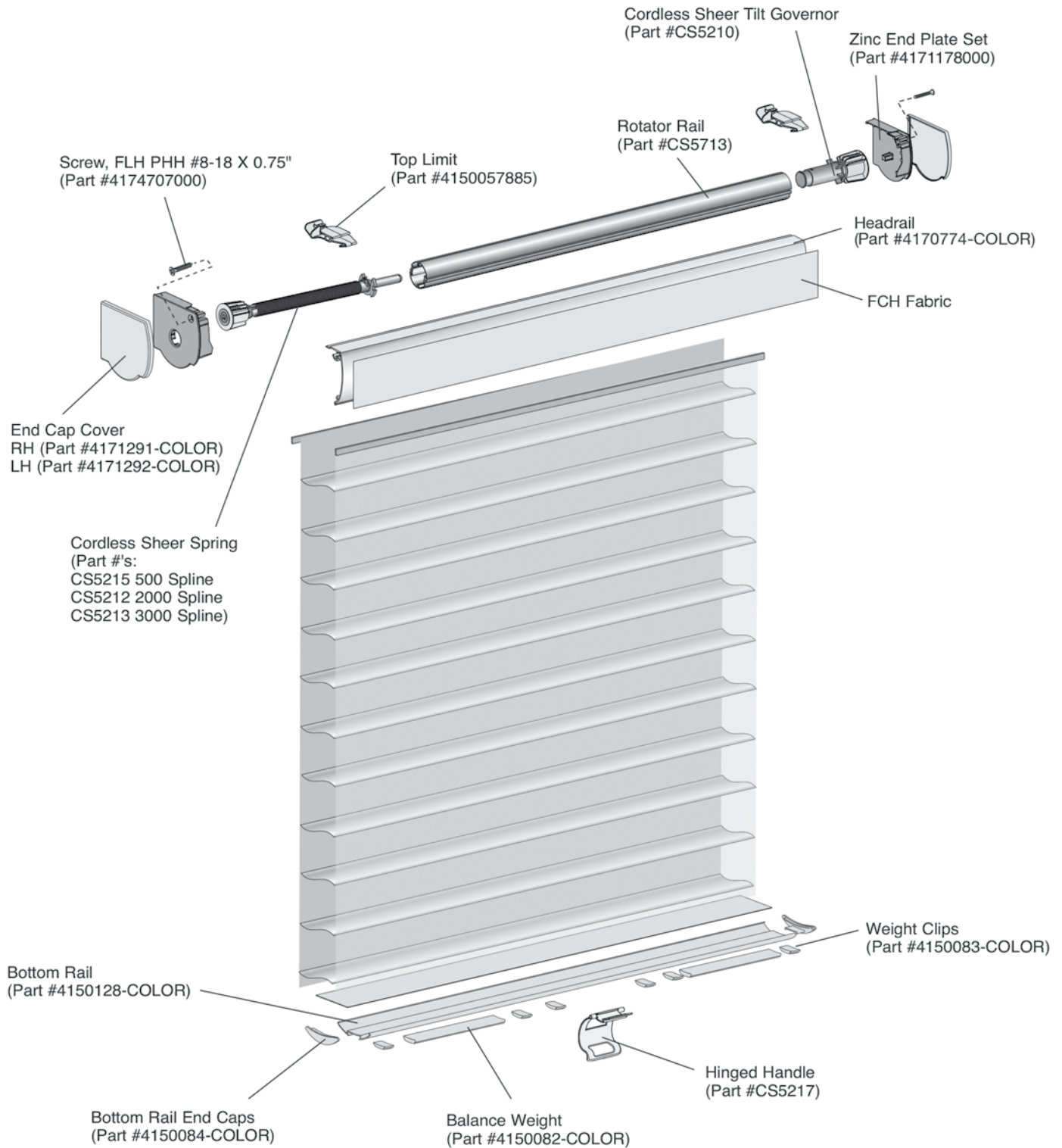

Sheer Shadings

7.4V RECHARGEABLE POWERTOCH HARDWARE SYSTEM | DESIGNER CASSETTE HEAD RAIL

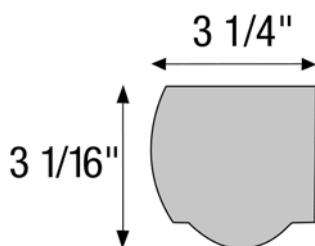

Rechargeable PowerTouch Rail Dimensions

- Depth of cassette: 3 1/4"
- Height of cassette: 3 1/16"

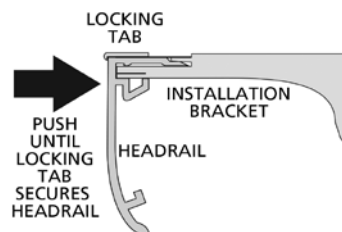

Hardware Features

Standard Designer Cassette	Choose from coordinating Fabric Insert or painted Smooth Face rail. Painted aluminum cassette head rail will be pre-coordinated to the fabric selection.
Bottom Rail Color	Color coordinated rail.

Mounting Dimensions

PowerTouch Hardware System

Minimum Depth Inside Mount	1"
Minimum Depth Flush Inside Mount	3 3/8"
Minimum Rear Fabric Clearance Inside Mount	1/8"
Minimum Surface Height Outside Mount	1"
Outside Mount Recommended Overlap Per Side	3"
Minimum Rear Fabric Clearance Outside Mount	1/8"

Finished Dimensions

Inside Mount

- Fabric will measure ordered width less: 1"
- Head rail* will measure ordered width less: 1/8"*

Outside Mount

- Fabric will measure ordered width minus: 3/4"
- Head rail will measure ordered width
- Fabric height will measure ordered length less: 1/8"

* Head rail measurements include endcaps.

Please Note: Due to variations in fabric weave and environmental conditions, the finished dimensions for both width and length may vary, plus or minus 1/8" from your order measurements.

Sheer Shadings

7.4V RECHARGEABLE POWERTOUCH HARDWARE SYSTEM | DESIGNER CASSETTE HEAD RAIL

PowerTouch™ Rechargeable Shades

Shadings can be fabricated with the PowerTouch Rechargeable Push Button Control option. The PowerTouch Rechargeable option is an easy, cord free motorized operation for the budget savvy homeowner. PowerTouch Rechargeable uses Simplicity motors and components.

PowerTouch Rechargeable Shades Operation

Press the up or down button on the pendant to raise or lower the shading to your desired position.

No programming is required with PowerTouch™, all programming is set at the factory. Upper and lower limits easily can be adjusted in the field if desired. Favorites position can be programmed on-site. Please refer to the installation instructions at comfortex.com/comfortex-dealers.

PowerTouch Appearance

- The PowerTouch Rechargeable wand and pendant is attached to the head rail and requires no additional mounting.
- The wand and pendant hangs down the front of the shades from the head rail. The wand does not touch the fabric.
- Pendant is 2½" long.



PowerTouch Rechargeable Color Options

- Shadings with Black or Oil Rubbed Bronze hardware will be built with black wand and pendants standard. All other colors will use white wand and pendants.

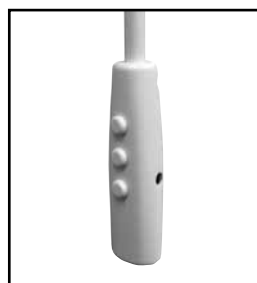

White



Black Shown with Plug-In Charger

PowerTouch Rechargeable Wand Length

Size and color must be specified when ordered. Below is a recommended size chart.

Shading Length	Standard Wand Length
Up to 30"	1' (12")
>30" to 52"	2' (24")
>52" to 78"	3' (36")
>78" to 100"	4' (48")
>100" to 120"	5' (60")

- Wand length is in 1 foot increments. 1 foot - 5 foot

Mounting Requirements for PowerTouch Rechargeable Shadings

- No special installation hardware or wiring requirements are needed.
- The wand and pendant do not need to be mounted to operate the shading.

PowerTouch Rechargeable Battery Life

The battery life will vary based on the type of window covering selected, the size and weight of the window covering and the number of times you operate the blind on a daily basis.

Battery Charger

8.4 Volt charger requires a standard power outlet to recharge the battery. Must specify charger when ordering a Simplicity PowerTouch Rechargeable Shading. The charger plugs into the charger port. The charger is black and comes with a 156" wire. The dimensions are 1" wide x 2½" length x 1¾" deep.



PowerTouch Wand and Pendant Location

The standard location for the wand and pendant is on the right. Please specify location when ordering.

Sheer Shadings

7.4V RECHARGEABLE POWERTOCH™ HARDWARE SYSTEM | DESIGNER CASSETTE HEAD RAIL

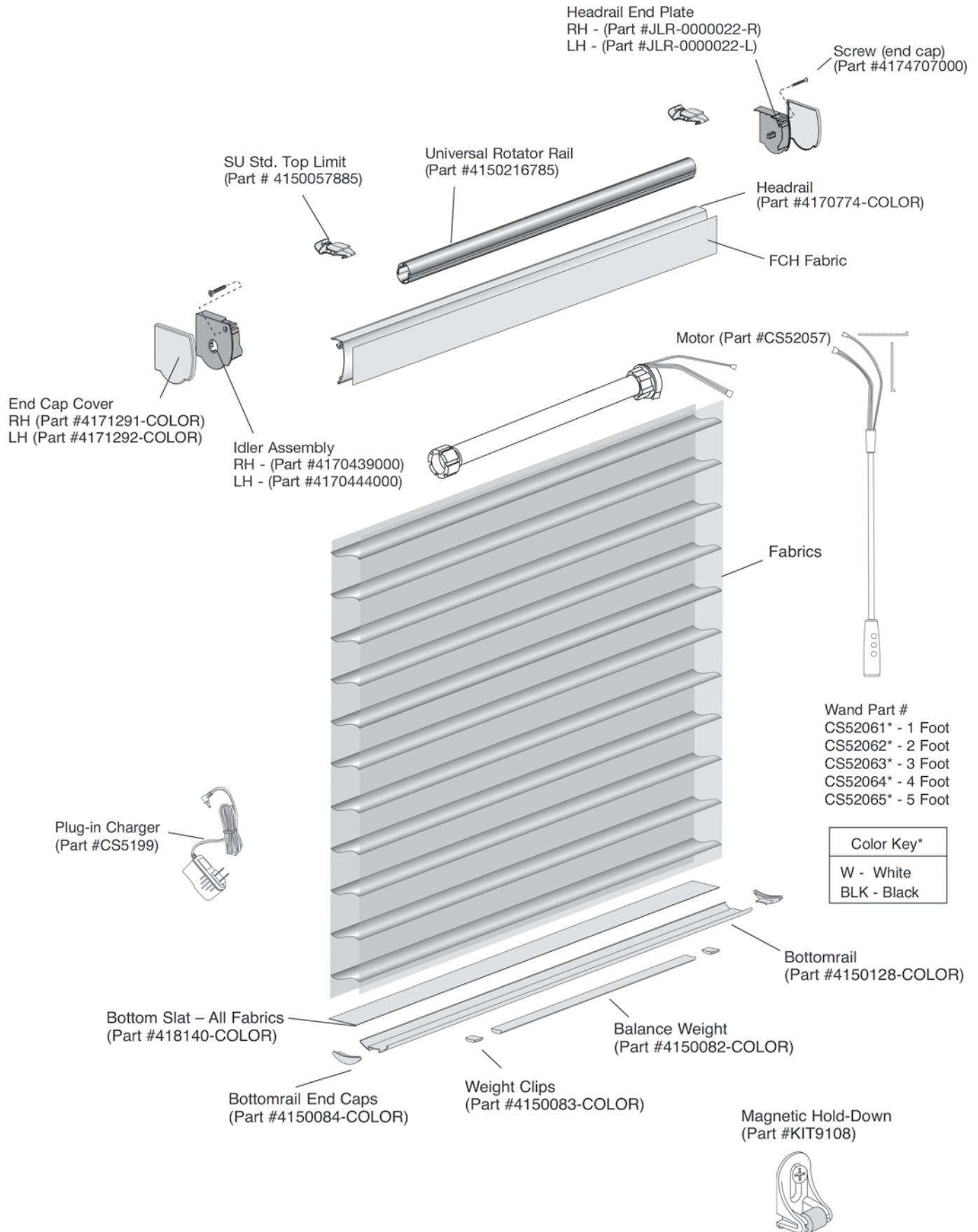

Sheer Shadings

7.4V RECHARGEABLE SIMPLICITY HARDWARE SYSTEM

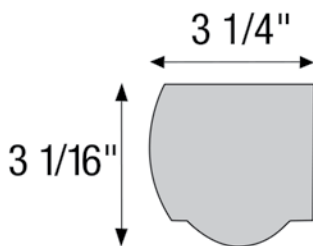

Rechargeable Simplicity Rail Dimensions

- Depth of cassette: 3 1/4"
- Height of cassette: 3 1/16"

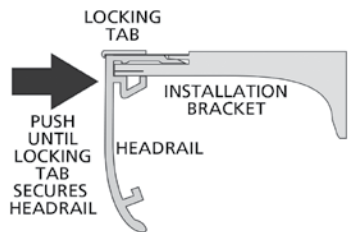

Hardware Features

Hardware colors for all fabrics	Choose from coordinating Fabric Insert or painted Smooth Face rail. Painted aluminum cassette head rail will be pre-coordinated to the fabric selection.
Cord	A nylon cord is standard.

Mounting Dimensions

Simplicity Integrated Rechargeable Hardware System

Minimum Depth Inside Mount	1"
Minimum Depth Flush Inside Mount	3 3/8"
Minimum Rear Fabric Clearance Inside Mount	1/8"
Minimum Surface Height Outside Mount	1"
Outside Mount Recommended Overlap Per Side	3"
Minimum Rear Fabric Clearance Outside Mount	1/8"

Finished Dimensions

Inside Mount

- Fabric will measure ordered width less: 1"
- Head rail* will measure ordered width less: 1/8"*

Outside Mount

- Fabric will measure ordered width minus: 3/4"
- Head rail will measure ordered width
- Fabric height will measure ordered length less: 1/8"

* Head rail measurements include endcaps.

Please Note: Due to variations in fabric weave and environmental conditions, the finished dimensions for both width and length may vary, plus or minus 1/8" from your order measurements.

Sheer Shadings

7.4V RECHARGEABLE SIMPLICITY HARDWARE SYSTEM

Simplicity Rechargeable Motors

The Rechargeable Simplicity Motor program features an integrated rechargeable lithium ion battery in the motor casing and is fully concealed by the roller tube.

PowerTouch Integrated Rechargeable Surcharges

See page 62 for shading standards and page 62 for surcharges and pricing example.

Simplicity Rechargeable Motors

No special installation hardware or wiring requirements are needed to install motorized Shangri-La Shadings with Designer Cassette Head Rail. No external battery wand is required.

Rechargeable Simplicity Motor Batteries

The battery for the integrated rechargeable simplicity motor system is integrated within the motor casing and is fully concealed by the roller tube.

Rechargeable battery comes fully charged from the factory.

Integrated Rechargeable Motor Battery Life

Rechargeable battery is included with the motor.

The average battery charge will last 6-12 months based on an average sized shade raised and lowered once per day. The life of the battery charge will vary based on the type of window covering selected, the size and weight of the window covering and the number of times the shade is operated on a daily basis.

The battery can be recharged up to 500 times. It takes approximately 5 hours to recharge the motor when fully depleted.



Charging Port

Integrated Rechargeable Motor Battery Charger

An 8.4 Volt charger requires a standard power outlet to recharge the battery. The charger must be specified when ordering an Integrated Rechargeable Simplicity Motorized shade. The charger plugs into the charging port of the motor. Required with Integrated Shading order. Sold separately.



The charger is black and comes with a 156" wire. The dimensions are 1" wide x 2½" length x 1¾" deep.

Simplicity Motor Hand Held Remotes

IMPORTANT: Simplicity Rechargeable Motorized Shadings are programmed at the factory with the "up and down" limits. The shades are **UNLINKED** from the remote so they are not able to operate during shipping. Each shade should be installed **before** linking it to the remote.

5 Channel Remote

The **5 Channel (5C) remote** can operate up to five shadings simultaneously, individually or in groups.

Simplicity (5C) remotes and holders are black in color. The remote comes with a holder which can be mounted to a wall for easy storage. The range of the remote is approximately 80 feet.



14 Channel Remote

This remote has 14-channels. Each channel has a setting to operate the bottom rail. The **14 Channel remote** can operate up to fourteen shades individually or 14 groups.

14 Channel remotes and holders are white in color. The remote comes with a holder which can be mounted to a wall for easy storage. The range of the remote is approximately 80 feet.



Please Note:

- Not all motors run at the same rate of speed.
- Simplicity motors have a "Favorites" or "MY" position setting. If the homeowner wants to set several shadings at the same intermediate position, follow instructions provided with installation manual.
- **WHEN ORDERING THE NEW INTEGRATED RECHARGEABLE, PLEASE ORDER THE NECESSARY BATTERY Charger** information.

Solar Panel Recharge Option

Plugs in to any Simplicity Rechargeable Remote control shade (does not work with PowerTouch). See page 56.



Dimensions of panel
18½" x 1½"

Sheer Shadings

7.4V RECHARGEABLE SIMPLICITY HARDWARE SYSTEM

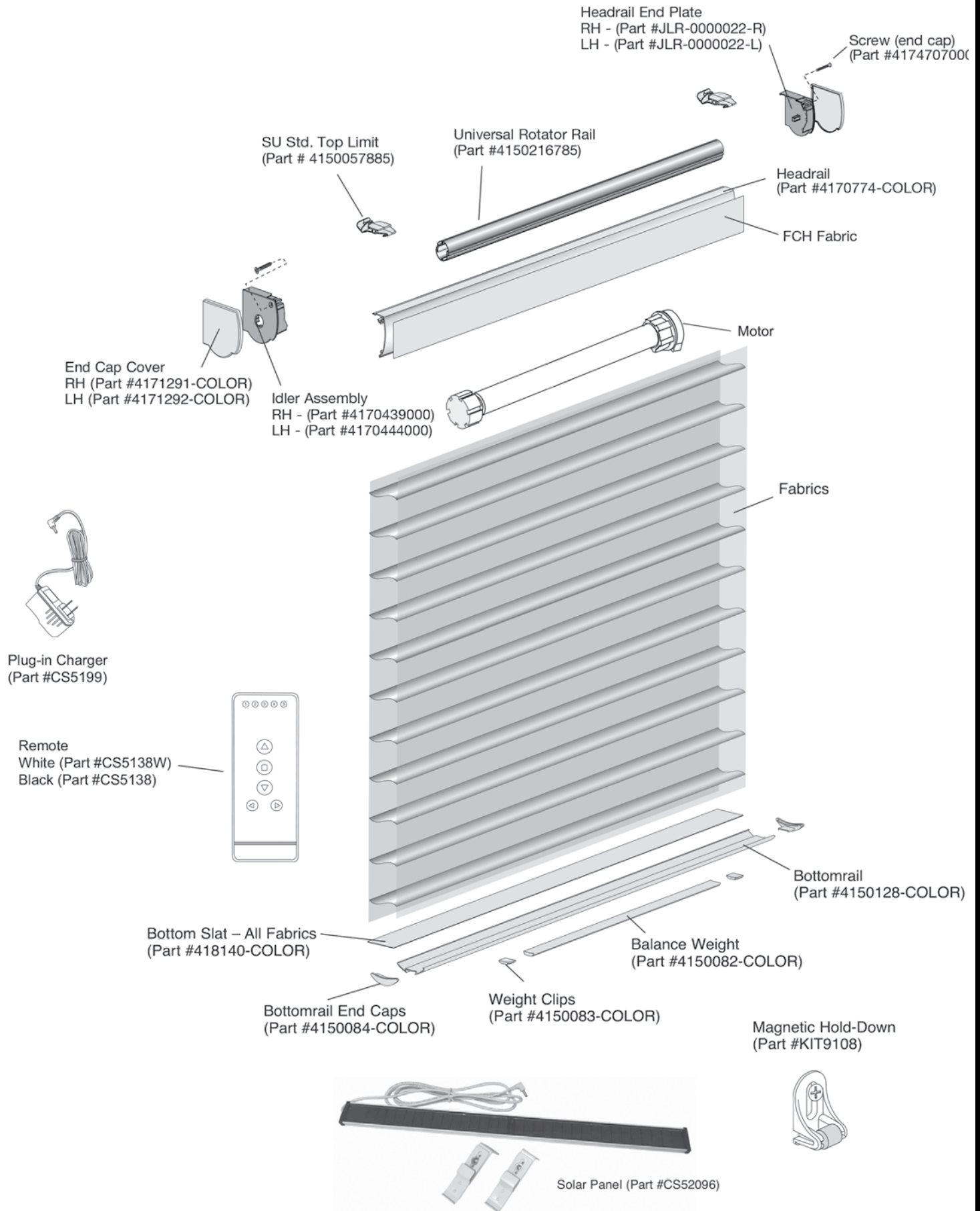

Sheer Shadings OPTIONS | ADDITIONAL NOTES

Optional Back Cover (Inside Mount)

Used with inside mounts to conceal the open rear side of the headrail for a more pleasing exterior look. Use of the back cover adds 1/4" to minimum inside mounting depths.

Minimum Inside Mounting Depth

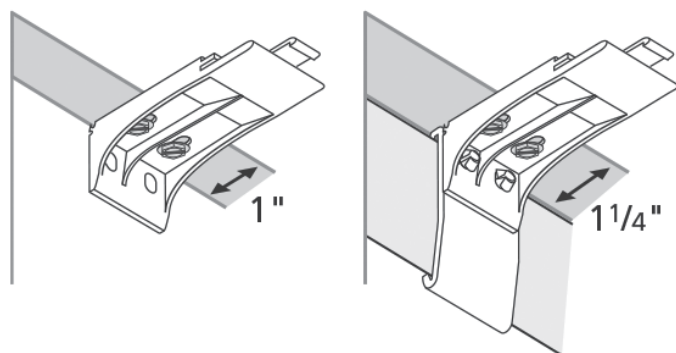

Without Back Cover

Back Cover

The back cover is secured in place by a back cover bracket attached to the installation bracket.

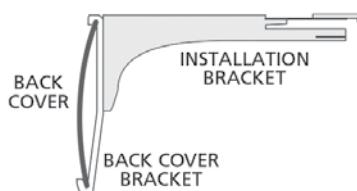

Back Cover Bracket

When a back cover is used, attach back cover brackets to the installation brackets before mounting them. Remove the tab from the top of the back cover brackets and both tabs at the rear of the installation brackets. After mounting the installation brackets, install the back cover.

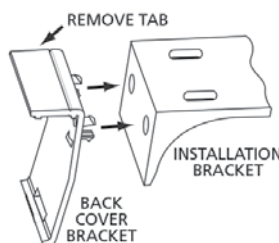

Optional Dust Cover (Outside Mount)

Shields the fabric and internal headrail components from dirt, dust, and other contaminants.

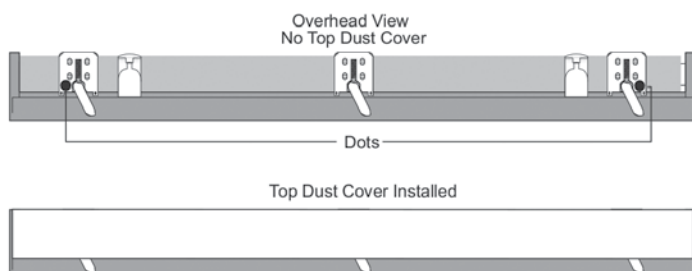

Shading Installation

Used with inside mounts to conceal the open rear side of To mount the shading, insert the top of the headrail into the brackets between the locking tab and the bracket flange. Push the headrail into the brackets until the locking tab clicks in place.

To remove the shading, lift the locking tab to release the headrail, rotate the headrail forward, and pull it straight out.

