

Sheer Solutions

Shangri-La® Sheer Horizontals & Stardust® Verticals

Reference Guide



FEATURING
Shangri-La Motorized Shadings and
Stardust Fascias Upgrades



Effective June 1, 2008

Not a suggested price list.
Prices are subject to change without notice.

36	417	469	524	573	627	681	731	785	921	1033	1138	1383
42	440	496	551	612	669	729	785	842	982	1102	1218	1485
48	466	525	588	648	711	774	840	905	1046	1173	1299	1590
54	484	550	618	687	755	824	898	971	1110	1243	1390	1741
60	506	581	651	723	796	876	953	1034	1169	1323	1483	1861
66	528	608	686	762	842	927	1016	1100	1232	1407	1577	1978
72	551	635	719	801	890	982	1072	1163	1299	1485	1669	2107
78	567	658	745	836	928	1025	1119	1219	1361	1559	1751	2214
84	591	686	776	878	978	1078	1185	1285	1432	1643	1846	2326
90	615	711	810	919	1025	1137	1241	1349	1501	1722	1940	2453
96	639	742	846	959	1072	1185	1297	1410	1571	1803	2031	2577
102	732	848	965	1091	1205	1316	1470	1613	1726	1962	2189	2649
108	772	892	1016	1147	1268	1387	1546	1699	1818	2063	2306	2787
114	818	946	1077	1218	1349	1475	1639	1802	1928	2189	2444	2958
120	878	1014	1156	1304	1439	1577	1752	1928	2064	2345	2617	3166
126	935	1078	1231	1388	1535	1681	1868	2058	2201	2498	2788	3375
132	997	1149	1312	1479	1635	1792	1992	2192	2346	2663	2972	3597

Add 10% for Paradise Fabrics with 3-Inch Vanes

Shadings in the boxed area will be built with UltraSleek Head Rail (max. shading size of 84" x 84"). UltraSleek cannot be motorized. Shadings outside the box will be fabricated with Deluxe Head Rail.

Head Rail Consistency If an order has multiple Shangri-La Shadings with varying drop sizes, we recommend building all shadings with Deluxe Head Rail. You must specify when ordering.



2" Vanes Paradise Collection of Light Filtering Fabrics with Roller System

Use the grid below to order the Paradise Fabric Collection Shading built on a custom roller system without a valance. The shading is operated with a bead chain.

Width In Inches

Add 10% for Paradise Fabrics with 3-Inch Vanes

Shangri-La Upgrades and Surcharges

Three-Inch Vane Paradise Fabrics:

Head Rail Options:

Battery Operated Motorized Shadings:

DoorStyles:

Add 10% to the grids listed above.

See page 8 for more information.

See pages 11-12 for more information.

See pages 4-6 for pricing and page 13 for more information.

Shangri-La Window Shadings Specifications

Custom Roller Operating System (only available with Paradise Fabrics)

(2-inch and 3-inch)

Width and Length Dimensions

Minimum Width:	12"	Maximum Width:	114"
Minimum Length:	12"	Maximum Length:	132"

Motors are not available on Shangri-La Sheer Horizontals Shadings with **Roller Operating System**.

Deluxe Head Rail

Paradise, Eternity and Linen Light Filtering Fabrics

(2-inch and 3-inch)

Width and Length Dimensions

Minimum Width:	12"	Maximum Width:	114"
Minimum Length:	12"	Maximum Length:	132"

Moonlight Room Darkening Fabrics

(2-inch and 3-inch)

Width and Length Dimensions

Minimum Width:	12"	Maximum Width:	114"
Minimum Length:	12"	Maximum Length:	122"

Motors are available on all Shangri-La Sheer Horizontals Shadings with **Deluxe Head Rail**. See pages 11-12 for more information.

Color Coordinated Aluminum Head Rail

All Fabrics

(2-inch and 3-inch)

Width and Length Dimensions

Minimum Width:	12"	Maximum Width:	114"
Minimum Length:	12"	Maximum Length:	96"

Motors are available on all Shangri-La Sheer Horizontals Shadings with **Color Coordinated Aluminum Head Rail**. See pages 11-12 for more information.

UltraSleek Head Rail

All Fabrics

(2-inch and 3-inch)

Width and Length Dimensions

Minimum Width:	12"	Maximum Width:	84"
Minimum Length:	12"	Maximum Length:	84"

Motors are not available on Shangri-La Sheer Horizontals Shadings with **UltraSleek Head Rail**. See pages 11-12 for more information.

DoorStyles Shadings Specifications

Minimum Width:	6"	Maximum Width:	72"
Minimum Length:	12"	Maximum Length:	72**

*Maximum length varies by width.

Please Note: Once ordered and manufactured, the width of the Shangri-La fabric cannot be altered. Comfortex makes deductions to the width of Shangri-La Window Shadings depending on the type of mounting indicated. For all mounting types, fabric will measure exactly the length ordered when the vanes are in the open or "view-through" position.

Shangri-La Sheer Window Shadings Finished Dimensions for Shangri-La Window Shadings with Roller Operating System

Inside Mount

- Bracket to bracket measurement: ordered width
- End to end roller width: ordered width minus $1\frac{1}{16}"$
- Fabric will measure ordered width minus: $1\frac{1}{4}"$
- Bottom rail will measure ordered width minus: $1\frac{1}{4}"$

Outside Mount

- Bracket to bracket measurement: ordered width plus $\frac{3}{16}"$
- End to end roller width: ordered width minus $\frac{7}{8}"$
- Fabric will measure ordered width minus: $1\frac{1}{16}"$
- Bottom rail will measure ordered width minus: $1\frac{1}{16}"$

Finished Dimensions for Shangri-La Window Shadings for Color Coordinated, Deluxe and UltraSleek Head Rail Systems

Inside Mount

- Head rail* will measure ordered width minus: $\frac{3}{16}"$
- Fabric will measure ordered width minus: $1\frac{1}{8}"$

Side (End) Mount

- Head rail* will measure ordered width minus: $1\frac{1}{16}"$
- Fabric will measure ordered width minus: $1\frac{5}{8}"$

Outside Mount

- Head rail* will measure ordered width plus: $\frac{3}{16}"$
- Fabric will measure ordered width minus: $\frac{3}{4}"$

Exact End to End Mount

- Head rail* will measure ordered width
- Fabric will measure ordered width minus: $1\frac{5}{16}"$

* Head rail measurements include end caps

Finished Dimensions for Shangri-La DoorStyles

Inside Mount

- Head rail* will measure ordered width minus: $\frac{3}{16}"$
- Fabric will measure ordered width minus: $\frac{5}{16}"$

Outside Mount

- Head rail* will measure ordered width plus: $\frac{3}{16}"$
- Fabric will measure the ordered width.

Exact Mount

- Head rail* will measure ordered width.
- Fabric will measure the ordered width minus: $\frac{3}{16}"$

Side Mount is not available for DoorStyles.

Please Note: Due to variations in fabric weave and environmental conditions, the finished dimensions for both width and length may vary, plus or minus $\frac{1}{8}"$, from your order measurements.

* Head rail measurements include end caps.

Shangri-La Sheer Window Shadings Shangri-La Shadings Style Options

All Shangri-La style options feature a continuous pull cord which allows for smooth, trouble free operation.

Metal Roller System

Only available with Paradise Fabrics

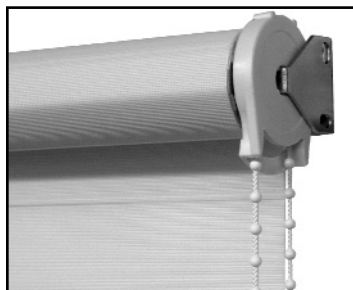

The metal roller is a traditional roller shade design.

A bead chain raises and lowers the shade.

Motorized Lift System is **not available** with standard roller.

UltraSleek Head Rail

(optional surcharge with Paradise fabric)

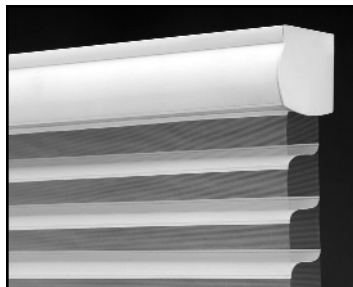

The UltraSleek Head Rail is white aluminum rail with a matching FABRIC insert. Comfortex will match the head rail insert to the selected fabric.

This head rail is STANDARD on Eternity, Linen and Moonlight fabrics on shadings up to 84" wide by 84" length.

This head rail is an optional upgrade for Paradise fabrics. See page 3 for more information.

UltraSleek Head Rail cannot be motorized.

Deluxe Head Rail

(optional surcharge with Paradise fabric)

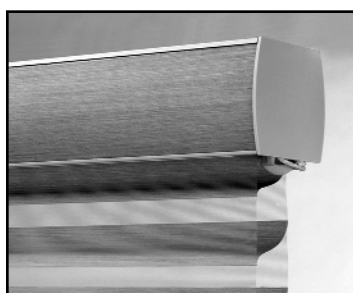

The Deluxe Head Rail is white aluminum with a choice of color coordinated aluminum or fabric inserts.

The FABRIC insert is STANDARD for the Deluxe Head Rail. Deluxe Head Rail is REQUIRED on Eternity, Linen and Moonlight Shadings over 84" wide by 84" long.

This head rail is an optional upgrade for Paradise fabrics. See page 3 for more information.

Deluxe Head Rail can be motorized.

Color Coordinated Aluminum Head Rail (optional surcharge with Paradise fabric)

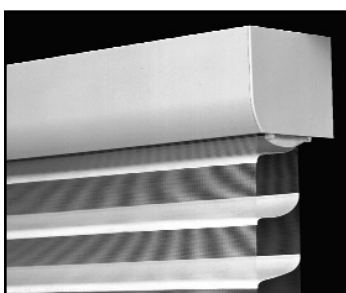

The Color Coordinated Aluminum Head Rail coordinates with Shangri-La fabric and must be specified when ordering.

This head rail is an optional upgrade for Paradise fabrics. See page 3 for surcharges.

Color Coordinated Aluminum Head Rail can be motorized.

DoorStyles



Shangri-La DoorStyles Shadings cover French doors, transoms and sidelights without a bulky head rail. Hardware matches the fabric.

DoorStyles attach to the window frame or door with hinges and tilt open and closed.

An operating handle allows the fabric to tilted open and closed. An operating pole is available for hard to reach applications.

Head Rail Consistency

For a consistent look, if an order has multiple Shangri-La Shadings with varying width and lengths outside the UltraSleek maximum sizes, we recommend ordering all shadings with Deluxe Head Rail. Please specify when ordering.

Fabric Collections and Vane Sizes

Shangri-La Window Shadings are available with four different fabric collections.

Collection	Opacity	Vane Size
Eternity	Light Filtering	2" and 3"
Paradise	Light Filtering	2" and 3"
Linen	Light Filtering	2"
Moonlight	Room Darkening	2" and 3"

Please Note: Moonlight is not a blackout fabric.

Knitted fabric may experience minor weave variations due to heat, humidity and other room conditions. These variations can result in light bowing, puckering and dimpling of the Shangri-La material. This is considered normal and does not constitute a failure in either workmanship or materials. The possible variations are minor and have been shown through case study not to detract from the beauty of the product.

Three Inch Fabric Colors

The following colors are available as 3" fabrics:

Light Filtering			
31000	Powder	31001	Vellum
31002	Hazelnut	31008	Champagne
31016	Sand	31200	Cumulous
31206	Breeze	31208	Feather
31218	Pebble	31216	Delicate
Room Darkening			
32200	Cloud White	32400	Horizon
32100	Starlight		

Shangri-La Sheer Window Shadings

Flame Resistance

Shangri-La fabric may be processed with a topical treatment to resist flames and adhere to strict flammability codes. For more information, contact Customer Service at (800) 843-4151.

Mounting Requirements for Shangri-La Hardware Systems

Custom Roller System (Figure A)

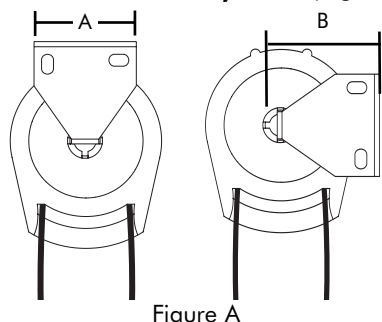

Figure A

- The metal roller used only on Paradise fabrics. It is available with two brackets in 1½" and 2" widths.
- Minimum depth for flush inside mount including installation brackets: 2½"

Standard Roller Bracket Dimensions

Standard Roller bracket dimensions are as follows:

A=1½"

B=1½" or 2"

Deluxe Head Rail (Figure B)

The Deluxe Head Rail is white aluminum with a choice of color coordinated aluminum or fabric inserts. **The fabric insert is STANDARD for the Deluxe Head Rail. Deluxe Head Rail is required on all Shangri-La Window Shadings over 84" wide x 84" length in Eternity, Linen and Moonlight Fabrics.**

Mounting Requirements for Deluxe Head Rail

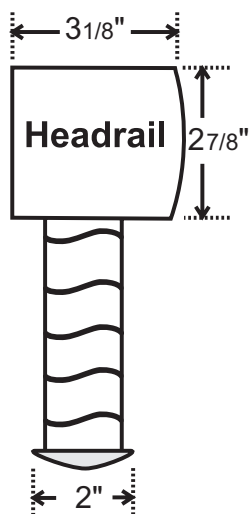

Figure B

- **Inside Mount:** Minimum depth or flush inside mount including the installation brackets: 3¾"
- **Shallow Mount:** Minimum depth required for mounting: ¾"
- **Side Mount:** Minimum depth for side mount: 1¼"
- Maximum shading width for side mount: 48"
- **Outside Mount:** Minimum surface area required for mounting: ¾"

Deluxe Head Rail Inserts

The fabric and aluminum inserts for the standard Deluxe Head Rail are available in the Shangri-La Eternity and Linen colors. The five Moonlight fabrics will be paired with the fabric or aluminum strips in the following Eternity colors:

Moonlight Fabric Color

Starlight 2100
Cloud White 2200
Aurora 2300
Horizon 2400
Moondance 2500

Insert Strip Color

Powder 1000
Vellum 1001
Hazelnut 1002
Sand 1016
Vellum 1001

Color Coordinated Aluminum Head Rail (Figure C)

The Color Coordinated Aluminum Head rail coordinates with Shangri-La fabric and must be specified when ordering.

Mounting Requirements for Color Coordinated Aluminum Head Rail

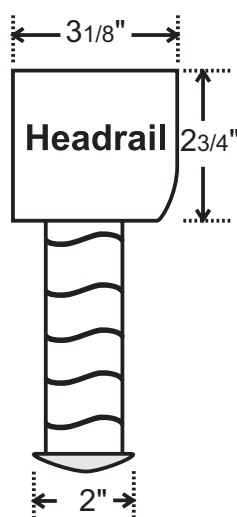

Figure C

- **Inside Mount:** Minimum depth for flush inside mount including installation brackets: 3¾"
- **Shallow Mount:** Minimum depth required for mounting: ¾"
- **Side Mount:** Minimum depth for side mount: 1¼"
- Maximum shading width for side mount: 48"
- **Outside Mount:** Minimum surface area required for mounting: ¾"

UltraSleek Head Rail (Figure D)

The UltraSleek Head Rail is white aluminum with a fabric insert. UltraSleek has a minimal light gap and standard on shades up to 84" wide by 84" length.

Mounting Requirements for UltraSleek Head Rail

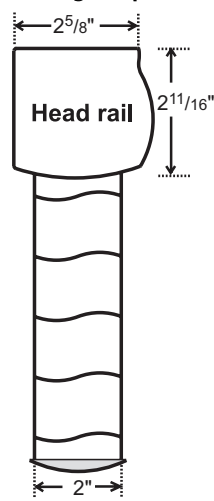

Figure D

- **Inside Mount:** Minimum depth or flush inside mount including the installation brackets: 2⅞"
- **Shallow Mount:** Minimum depth required for mounting: 1⅞"
- **Side Mount:** Minimum depth for side mount: 1⅞"
- Maximum shading width for side mount: 48"
- **Outside Mount:** Minimum surface area required for mounting: 1"

Reverse Roll with Deluxe, Color Coordinated Aluminum and UltraSleek Head Rails

The braided polyester cord does not have a reverse roll stop on shadings with the Shangri-La Hardware Systems. If a shading with the Deluxe, Color Coordinated Aluminum or the UltraSleek Head Rail is raised above 24" in the reverse roll mode, there is a possibility of the fabric rubbing on the head rail. Comfortex reserves the right NOT to warrant wear and tear of fabric if damaged by roll-up in excess of 24".

Shangri-La Sheer Window Shadings

Length Considerations with Shangri-La Shadings

Comfortex will fabricate your Shangri-La Window Shading to the exact length ordered, when the vanes are in the open (or view-through) position. When the vanes are rotated to the closed position, the shading will become $\frac{3}{8}$ " longer.

When closed on an inside mount, a slight puckering may occur on the lower most sheer section because of contact with the sill. To compensate, slightly raise the shading until the rail begins to lift off the window sill.

If preferred, Shangri-La can be ordered $\frac{3}{8}$ " less than the measured length of the window opening. In this case, the bottom rail will be positioned $\frac{3}{8}$ " above the sill when the vanes are in the open position. (Figure E) Rotating the vanes closed will cause the bottom rail to touch the window sill, closing any space.

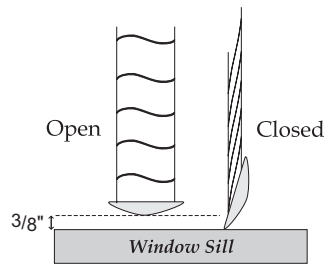

Figure E

See page 13 for information on the length considerations on Shangri-La DoorStyles Shadings.

Side by Side Alignment

When Shangri-La Window Shadings are installed side-by-side, vane alignment can be guaranteed within $\frac{1}{4}$ " only if:

- The shadings are the same color and ordered at the same time.
- The sum total of the widths of all shades needing alignment is less than 102".
- Side-by-side lineup is specified when the order is placed.

Omni-View System for Shangri-La Hardware

Shangri-La with Deluxe, UltraSleek and Color Coordinated Aluminum Hardware Systems feature the Omni-View™ Cord System. The Omni-View System provides the ability to manipulate the shading into various viewing positions. Consequently, there are variations in visibility through the shadings when the vanes are tilted to their maximum open positions. The following five modes can be obtained with standard shading operation when viewing the shading at eye level.

- **Closed top, open bottom:** By partially lowering the shading from the fully raised position, the upper portion of your window will become semi-opaque while allowing a clear view below.
- **Fully private:** When lowered completely, Shangri-La provides complete privacy and softly diffused light.
- **Partially open:** Opening Shangri-La slightly will gradually increase the level of light and allow varying levels of view through.
- **View-through when lowered** - By completely opening the vanes, Shangri-La provides a softened, veiled view to the outside.
- **View-through when raised** - From the open or view-through position, continuing to pull down on the back of the cord will raise the fabric allowing a clear view outside from below, and a veiled view above. This exclusive feature allows Shangri-La to be raised up to 24" in this mode.

Cord Information for Paradise Roller Shadings

A beaded cord loop is the only cord option available with the custom roller system used with the Paradise Fabric Collection. The cord loop will measure the length indicated below unless otherwise specified.

Shading Length*	Standard Loop
12" - 36"	2' (24")
36" - 48"	3' (36")
48" - 72"	4' (48")
72" - 96"	5' (60")
96" - 120"	6' (72")
120" - 132"	7' (84")

Cord Information for Deluxe, Color Coordinated Aluminum and UltraSleek Head Rails

Shangri-La Windows Shadings utilizing the Deluxe and Color Coordinated Aluminum head rail systems feature a braided polyester cord to raise and lower the shading. Shadings with the UltraSleek head rail system utilize a beaded cord loop. The cord loop will measure the length indicated below unless otherwise specified.

Shading Length*	Standard Loop
12" - 36"	2' (24")
36" - 48"	3' (36")
48" - 72"	4' (48")
72" - 96"	5' (60")
96" - 120"	6' (72")
120" - 132"	7' (84")

Maximum cord length is 15 feet. Polyester cord can be ordered in custom lengths in **1 foot increments only**.

* UltraSleek Head Rail maximum shading length is 84".

Warranty on Polyester Cord with Deluxe and Color Coordinated Aluminum Hardware

The braided polyester cord does not have a reverse roll stop on shadings with the Shangri-La Hardware Systems. If a shading with the Deluxe or Color Coordinated Aluminum Head Rail is raised above 24" in the reverse roll mode, there is a possibility of the fabric rubbing on the head rail. Comfortex reserves the right NOT to warrant wear and tear of fabric if damaged by roll-up in excess of 24".

Motorized Shangri-La Sheer Horizontals

Shangri-La Sheer Horizontal Window Shadings are motorized with the Somfy™ Radio Technology (RTS) System. The motors will fully operate the shadings with radio frequency technology.

Shangri-La Hardware Available with Somfy Motors

The motors fully operate the shadings using Deluxe and Color Coordinated Aluminum head rail.

Motors are **not available** with UltraSleek head rail or roller system.

The Shangri-La Sheer Horizontal Motorized Lift System includes a standard 12 volt battery wand with eight AA lithium batteries. The remotes, wall switches and timers are sold separately and can be used in conjunction with one another. Prices are as follows:

Mounting Requirements For Motorized Shadings

No special installation hardware or wiring requirements are needed to install Shangri-La Window Shadings with motor, see page 9 for mounting information.

Battery Wand

Mounting Options

The battery wand comes with two mounting options:

- **Head rail mount:** Battery wand clips are mounted on the back of the Shangri-La head rail using a high temperature pressure sensitive adhesive.
- **Wall mount:** Battery wand clips are mounted to the wall.

The battery wand measures 17" and comes with eight lithium batteries and is white in color. The shade must be removed from the window to change batteries. Extension wires are available at 48" and 96" for use with the battery Wand.

Battery Life

The battery life will vary based on the type of window covering selected, the size and weight of the window covering and the number of times you operate the shade on a daily basis.



Battery Wand

For example, a 36" x 60" single honeycomb shade operated twice daily will have a battery life which lasts up to 18 months.

Battery Replacement

Eight lithium batteries are included with the wand. Recommended replacement batteries are Energizer® AA lithium. These batteries are commonly found in department stores, home improvement centers, grocery and hardware stores.

Shangri-La Sheer Window Shadings

Remote Options

There are two remote options Both are available with 1 or 5 channel options. Please specify when ordering:

- Hand Held
- Wall Switch

Hand-Held Remote Option

The 1 Channel RTS Remote will operate all of the shades simultaneously.

The 5 Channel RTS Remote can operate up to five shadings or groups of shadings individually. When ordering, please specify which channels are assigned to each shade.

RTS 1 Channel Remote



RTS 5 Channel Remote

The remote control utilizes one 3V lithium battery (CR2430). Batteries are included.

Wall Switch Option

The RTS System has a wall switch option upgrade. The wall switch works just like a light switch to operate your shades. The switch is easy to install with an standard single gang electrical box and does not require any wiring.

There are two wall switch options:

- 1 Channel
- 5 Channel

Please specify when ordering.

The 1 Channel RTS Wall Switch will operate all of the shades simultaneously. The 5 Channel RTS Wall Switch can operate up to five shades or groups of shades individually.

The wall switch is available in two colors: white and ivory. Please specify when ordering.



RTS 1 Channel Wall Switch



RTS 5 Channel Wall Switch

Overall dimensions: Length: 4½" Width: 2¾" Depth: 1¼"
RTS Wall Switches use one 3V lithium battery (CR2430). Batteries are included.

RTS System Wireless Timer

The RTS System Wireless Timer allows you set specific times for your shades to be raised or lowered. The Wireless Timer can be programmed to operate at the same time each day or different times every day. It has a security function that will raise or lower shades randomly to give the impression of an occupied home. Commands are transmitted via radio, so external wiring is not necessary.



RTS System Wireless Timer

Overall Dimensions: Length and Width: 3½" Depth: 1"
Wireless Timers use two 1.5V DC (AAA) batteries. Batteries are included.

RTS System Wireless Timer with Sun Sensor

The RTS System Wireless Timer with Sun Sensor has the same features as the same as the timer shown above, but can also be programmed to raise and lower your shades according to the intensity of incoming sunlight. Commands are transmitted via radio, so external wiring is not necessary.



RTS System Wireless Timer with Sun Sensor

Overall Dimensions: Length and Width: 3½" Depth: 1"
Wireless Timers use two 1.5V DC (AAA) batteries. Batteries are included.

DC Power Supply

12 Volt DC power supply is available and requires a standard power outlet to power the motor. The power supply must plug in to the motor.

Battery Operated Motorized Shadings Warranty

Somfy warrants their motors and motor control systems to be free from defects in materials and workmanship under normal and proper use for a period of five years starting from the date stamped on the motor. Mechanical, electrical and electronic accessories are warranted for one year from the date of invoice. Batteries are not covered by the warranty. Please see page 28 for complete Comfortex warranty information.

Shangri-La Sheer Window Shadings

Shangri-La DoorStyles Shadings

Shangri-La DoorStyles Shadings cover French doors, transoms and sidelights a look of sheer perfection without a bulky head rail. They attach to the window frame or door with unobtrusive hinges and tilt open and closed with easy to install hardware. An operating handle allows the fabric to tilted open and closed (Figure F).

Fabric

All light filtering and room darkening fabric collections are available as DoorStyle Window Shadings.

Rails and end caps on Shangri-La DoorStyles Shadings are matched to the fabric color.

DoorStyles Hinges and Operating Handles

Hinges and operating handles are available in three colors:

- White
- Brass
- Silver

White is standard. Please specify when ordering.

Operating Pole

An operating pole is available for hard to reach windows and doors. Please specify when ordering.

6 Foot Expandable Pole:	\$54.00
12 Foot Expandable Pole:	\$67.00

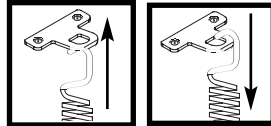

Mounting Requirements for Shangri-La DoorStyles

- **Inside Mount:** Minimum depth for flush inside mount including installation hinges: $2\frac{5}{8}"$
- **Shallow Mount:** Minimum depth required for mounting: $1\frac{1}{2}"$
- **Outside Mount:** Minimum surface area required for mounting: $\frac{3}{4}"$

Side Mount is not available for DoorStyles.

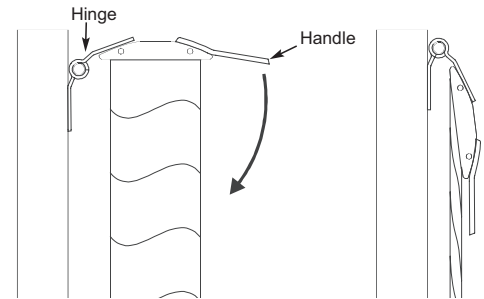
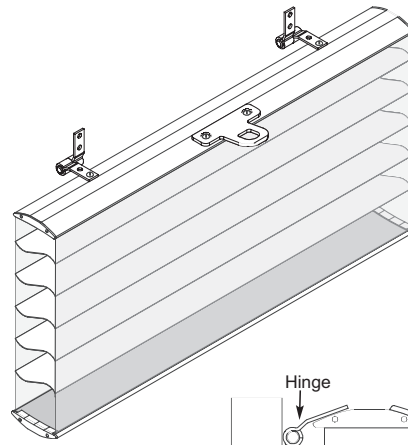
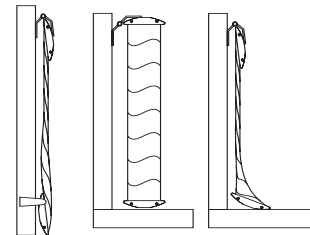

Figure F

Length Considerations with Shangri-La DoorStyles

Comfortex will fabricate your Shangri-La DoorStyles to the exact length ordered when the vanes are in the open (or view through) position. When the vanes are tilted to the closed position, the shading will become $1\frac{3}{4}"$ longer.

When closed on an inside mount or when used with hold down brackets, a slight puckering may occur.



Shangri-La Sheer Window Shadings Vane Opening and Visibility

Vanes on the three styles of Shangri-La fabrics open to slightly different degrees. Consequently, there are variations in visibility through the shadings when the vanes are tilted to their maximum open positions. The variations among the products are shown in the below illustration when looking through the shading $\frac{1}{4}$ of the way up from the bottom.

2" Light Filtering Fabrics

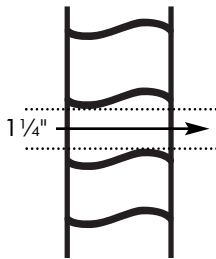

2" Room Darkening Fabrics

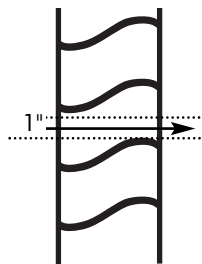

3" Fabrics

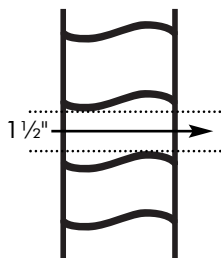

Vane Closure (Figure G)

Shangri-La vanes are not designed to close tightly. The inherent nature of the fabric will cause a slight increase in the distance from the front sheer to back sheer as you move further down the shading. These vanes do not form a perfect seal against light leakage which is most visible toward the bottom of the shading. Vane overlap ensures that privacy is not compromised.

Vane closure is measured as the distance between the front and rear fabric sheers 6" up from the lowest point of the bottom rail, with the shading fully lowered and the vanes closed. On light filtering fabrics, the maximum distance from the front sheer to the back sheer when closed is $\frac{7}{8}$ ". On room darkening fabrics, the distance is $\frac{5}{8}$ ".



Figure G

Measuring Instructions for Shangri-La Sheer Horizontals

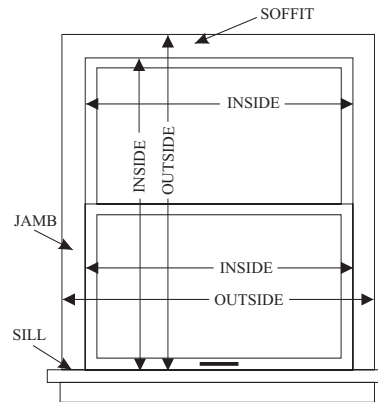

Important Measuring Guidelines for Shangri-La

Comfortex accepts measurements down to $\frac{1}{8}$ " increments. Measurements with 16th (ex. $\frac{1}{16}$ ") increments will not be accepted.

Precise width and length measurements are critical. Fabric width cannot be altered after the shading is fabricated.

Please use a metal tape measure for accuracy from home to factory.

The head rail must be installed perfectly level and installed evenly to ensure smooth operation. On an inside mount, it is recommended that you check to see that the mounting surface is level and consistent. If your soffit needs to be leveled, this should be done before measuring.

Inside Mount

Measure across the width of your window opening in three different places - top, middle and bottom. Measurements should be taken within the window jamb. Provide the smallest of the three measurements to Comfortex. Be exact. Comfortex will make the necessary deductions to fit the window opening.

Measure the length of the window opening from the underside of the soffit to the surface of the window sill in two places - use the smallest of these two measurements.

Outside Mount

Measure the exact width and length of the area to be covered. On the width, allow at least $1\frac{1}{2}$ " of an overlap on each side. An overlap of 3" on each side is recommended.

Be sure to take into consideration any obstructions such as window trim, molding, locks and window cranks.

Side Mount

Side mount is not available for the roller system used with Paradise Shadings or with DoorStyles Shadings.

Shangri-La may be side mounted using "L" brackets. For side mounts, follow the instructions for inside mounts. An additional $\frac{1}{2}$ " will be taken off the standard inside mount deduction to allow room for the "L" brackets.

The maximum shade width utilizing the side mount option is 48".

Hardware

Head Rail Measurements

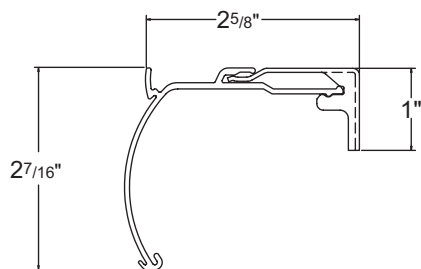

UltraSleek Head Rail

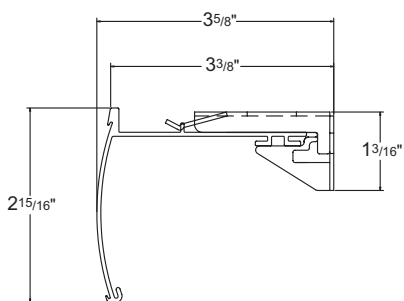

Deluxe Head Rail

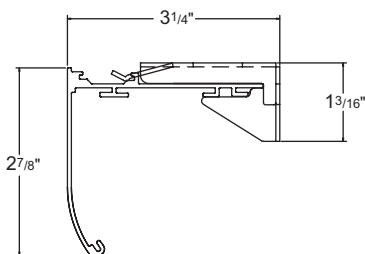

Color Coordinated Head Rail

Hold Down Brackets: Shangri-La hold down brackets are made of a clear plastic which fit into holes in the endcap of the bottom rail.

Extension Brackets

Extension or "L" brackets are available to project the back of the shade from the mounting surface. Those shading with metal roller system, it will project 2 1/2". The extension brackets for UltraSleek, Deluxe and Color Coordinated Aluminum Head Rail project it 4 1/4".

Spacer Blocks

Spacer blocks project the shading 3/8" from the mounting surface. Use spacer blocks to obtain clearance when obstructions, such as window cranks or door handles, obstruct the movement of the shading.

Shangri-La Sheer Window Shadings

Leveling Shangri-La Sheer Horizontals

Shangri-La Window Shadings are leveled and weighted in the factory. When installed level, the fabric will not skew when raised. If the head rail is not installed level, skewing can occur that can damage the edge of the fabric. Be sure to follow the installation instructions carefully to ensure correct and balanced operation.

Skew Adjusting Bottom Rail

After installation, windows that are not square and level may cause the shadings to shift to one side as it rolls up, requiring adjustment of the bottom rail.

Bottom rail endcaps are weighted with two weights on each side. Remove endcap from rail on the finished shading. Weights are added or removed to adjust skewing. Add weight to the side the fabrics shifts to, or remove weight from the opposite side.

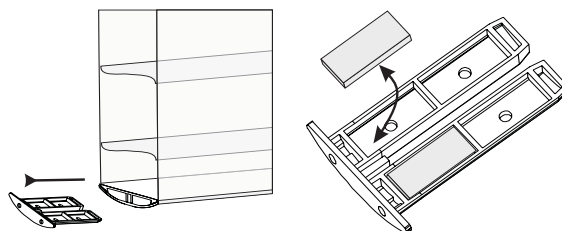

Remove endcap from rail on finished shading

Add or remove weights to adjust

Please Note: 2-inch and 3-inch Shangri-La vanes both utilize the 2" skew adjusting bottom rail.

Shangri-La Sheer Window Shadings

Shangri-La Features at a Glance

- Shangri-La is a window shading of unique beauty and performance for the finishing touch to a beautiful window and room.
- Horizontal fabric vanes float between two layers of soft, knitted fabric sheers, to soften your view outside with a choice of fabrics.
- Shangri-La is available to widths of 114" and drops to 132" to provide visual elegance to the widest of windows.
- Shangri-La is available in 2-inch and 3-inch vane widths in both light filtering and room darkening fabrics.
- Shangri-La's 3-inch vane fabrics provide greater view through with our most popular colors.
- Vanes glide from open to closed to out of sight with elegant hardware.
- A choice of translucent or room darkening fabrics coordinate beautifully with Stardust Soft Sheer Verticals and Harmony™ Cellular Verticals.
- Only the Omni-View cord system provides five distinctly different variations of vane position for numerous combinations of privacy, view and light control.
- Only with Shangri-La, partially raise the shading with the fabric vanes in the open, view-through position so you keep your view and still feel the outdoor breeze.
- The award winning Shangri-La DoorStyles Shadings give French doors, transoms and sidelights a look of sheer perfection without bulky head rail.
- A variable weight system hidden in the bottom rail allows for on-the-spot skew adjustment for a balanced appearance in the window.
- The sophisticated array of Shangri-La colors is designed to flatter your decor.
- Three Head Rail Styles are available for Shangri-La Window Shadings: the low light gap UltraSleek, the Deluxe Head Rail or the Color Coordinated Aluminum Head Rail help to create your customers own sophisticated look.
- Battery operated motorized shadings are available.
- A low side light gap provides minimal light leakage on shading sides and above the head rail for increased privacy.
- Easy to install hardware and brackets allow for effortless installations and easy removal for cleaning.
- Shangri-La may be ultrasonically or traditionally cleaned to stay bright and beautiful.
- A Limited Lifetime Warranty serves as a commitment to your satisfaction.

Cleaning and Care

The soft, delicate feel of the Shangri-La fabric belies the durability of the material. Shangri-La is made from a sturdy, knitted polyester fabric which can be feather dusted or vacuumed at a low setting. Spots or stains can be lightly rubbed clean with a damp sponge and mild soap. To avoid discoloration of the material, we recommend against the use of chemical cleaners.

Precautions should be taken to reduce exposure to harsh environmental elements, such as salt air. Continuous exposure to salt air through open windows and doors will accelerate fabric deterioration over time.

Important: Do not clean the fabric using electrostatic wipes such as Swiffer® or Pledge Grab-It®.

Shangri-La fabric may also be ultrasonically cleaned.

ON-SITE™ Corporation provides shade and blind cleaning services. For more information, visit www.on-sitecorp.com or to find a ON-SITE dealer nearest you check the yellow pages or simply call 800-598-9043. Comfortex acknowledges these cleaning methods as being safe and effective. We cannot attest to the quality of equipment or services provided by any independent cleaning facility.

For additional advice on care or cleaning, please contact the Comfortex Technical Service Department at 800-843-4151.

Child Safety

Be aware that it is possible for children to become entangled in window coverings cords. To reduce the risk of accidents, all cords must be kept out of the reach of children.

The cord tensioner used on Shangri-La continuous cord loops keeps the cord taut to prevent children and pets from entangling and subsequently injuring themselves.

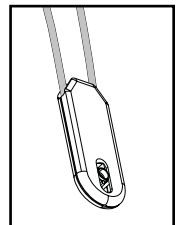

Cord tensioner